

Garvey Del Mar Plaza

7801-7825 Garvey Avenue, 3012 Del Mar Avenue, and 3017 Brighton Street
(NEC Del Mar Avenue and Garvey Avenue)

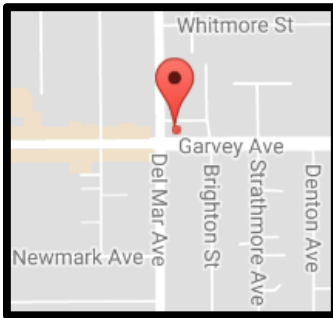

- Plans Approved
- 60 Residential Condominiums
- 14,565 s.f. - Retail/Restaurant/Office (Basement/First Floor)
- 120 Commercial Parking Spaces (surface and basement)

*For more information, please contact the City of Rosemead Planning Division at (626) 569-2140.

Site Plan

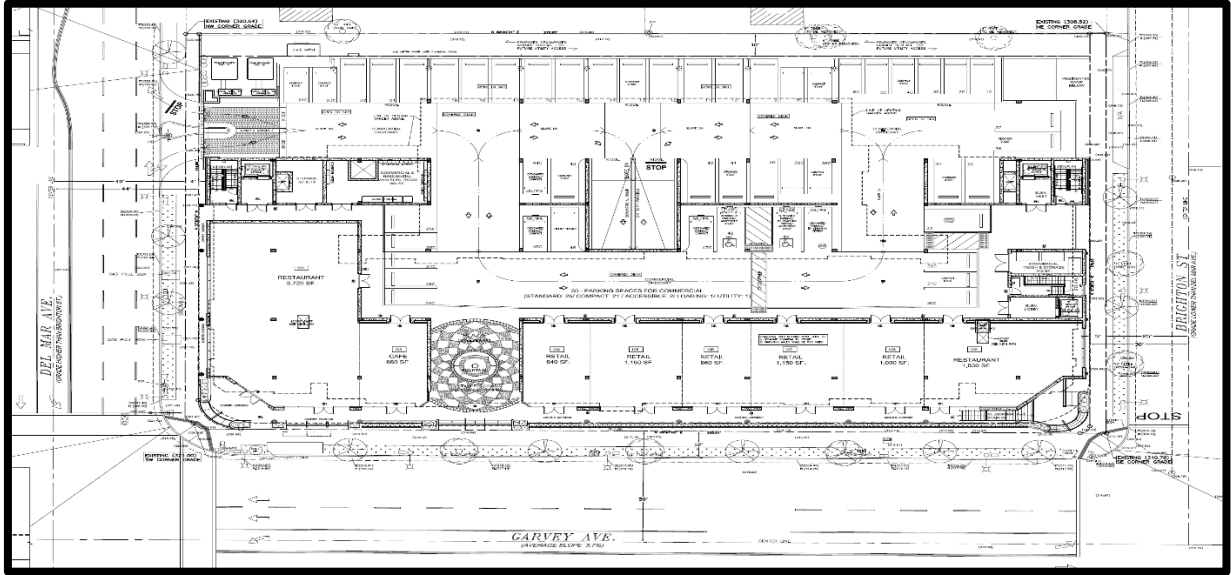

Retail/Restaurant/Office Floor Plan

